

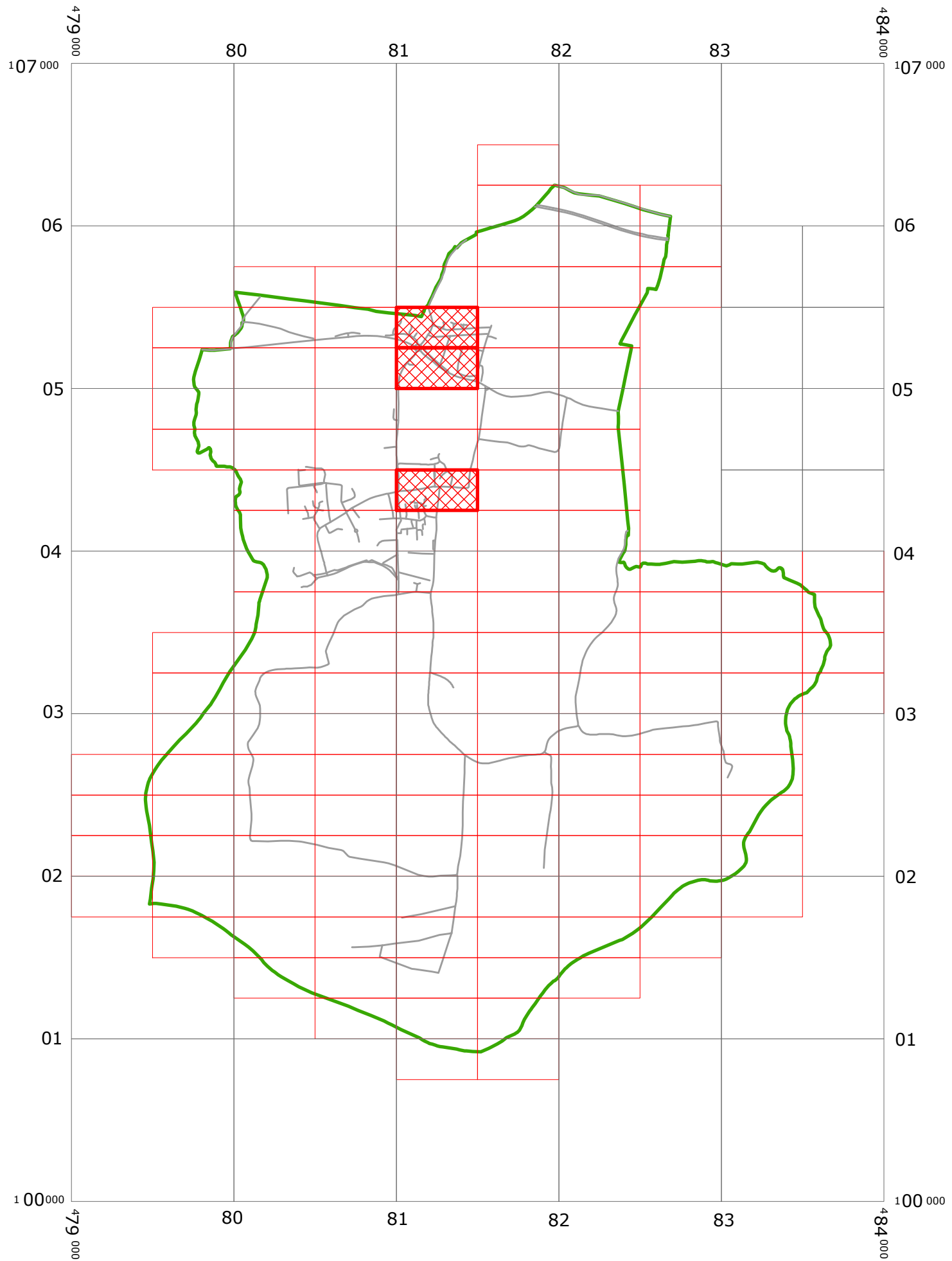





WEST SUSSEX COUNTY COUNCIL
((CHICHESTER DISTRICT) (PARKING PLACES AND TRAFFIC REGULATION)
(CONSOLIDATION) ORDER 2010)
(BOSHAM, VARIOUS ROADS AMENDMENT) ORDER 2011

BOSHAM: LOCATION OF WAITING RESTRICTIONS



KEY:

-  OS TILE GRID
-  PARKING TILE GRID
-  LOCATION OF WAITING RESTRICTIONS
-  BOSHAM PARISH BOUNDARY
-  BOSHAM ROAD NETWORK



West Sussex County Council
 Infrastructure
 The Grange
 Tower Street
 Chichester
 West Sussex
 PO19 1RH

WEST SUSSEX COUNTY COUNCIL
 ((CHICHESTER DISTRICT)
 (PARKING PLACES AND TRAFFIC REGULATION)
 (CONSOLIDATION) ORDER 2010)
 (BOSHAM, VARIOUS ROADS AMENDMENT) ORDER 2011

LOCATION OF WAITING RESTRICTIONS



Reproduced from or based upon 2010 Ordnance Survey mapping with permission of the Controller of HMSO (c) Crown Copyright reserved. Unauthorised reproduction infringes Crown copyright and may lead to prosecution or civil proceedings West Sussex County Council Licence No. 100023447

SCALE: 1:30,000
 03/06/2011

Key for Waiting Restrictions

All areas over which the provision of the orders apply are defined by the shaded areas as shown on the following plans plus a contiguous area not indicated on the plans of verge and/or footway between the carriageway edge and the highway boundary. The plans in this schedule are based upon grid references of the Ordnance Survey National Grid defined by the OSGB 36 triangulation.

Prohibition of waiting

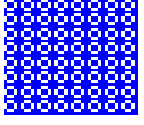
- | | | | |
|-----|---|--------|----------------------------------|
| 101 |  | check | No waiting at any time |
| 144 |  | pat079 | No waiting 8.00am-4.00pm Mon-Fri |

Clearways

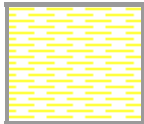
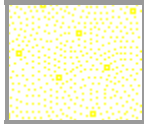
- | | | | |
|------|---|---------|---|
| 1104 |  | usgs620 | Bus stop clearway 7.00am-7.00pm any day |
| 1111 |  | usgs677 | School Keep Clear 8.00am-4.00pm Mon-Fri |

WEST SUSSEX COUNTY COUNCIL
((CHICHESTER DISTRICT) (PARKING PLACES & TRAFFIC REGULATION)
ORDER 2010)

(BOSHAM: VARIOUS ROADS) (AMENDMENT OF WAITING RESTRICTIONS)
ORDER 2011

West Sussex County Council in exercise of their powers under Sections 1 (1) 2 (1) and (2), 4 (2), 45, 46, 49 and 53 and Part IV of Schedule 9 of the Road Traffic Regulation Act 1984 ("the Act") as amended and of all other enabling powers and after consultation with the Chief Officer of Police in accordance with Part III of Schedule 9 to the Act hereby make the following Order:-

1. This Order shall come into operation on the Second day of June 2011 and may be cited as "West Sussex County Council ((Chichester District) (Parking Places & Traffic Regulation) Order 2010) (Bosham: Various Roads) (Amendment of Waiting Restrictions) Order 2011".
2. The "West Sussex County Council (Chichester District) (Parking Places & Traffic Regulation) Order 2010" is hereby amended by the replacement of the plan specified in the First Schedule to this Order, with the plan specified in the second schedule to this Order, attached hereto.
3. The "West Sussex County Council (Chichester District) (Parking Places & Traffic Regulation) Order 2010" is hereby amended by the insertion of the plans specified in the Third Schedule to this Order, attached hereto.

FIRST SCHEDULE
Plan to be Replaced

SU8104SWN (Issue Number 1)

SECOND SCHEDULE
Replacement Plan

SU8104SWN (Issue Number 2)

THIRD SCHEDULE
Plans to be Inserted

SU8105SWN (Issue Number 1)
SU8105SWS (Issue Number 1)

THE Common Seal of THE
WEST SUSSEX COUNTY COUNCIL
was hereto affixed the *SECOND*

day of *JUNE* 2011

M Kendall
Authorised Signatory
CHS-009-MM

)
)
)
)
)
)
)
)
)
)

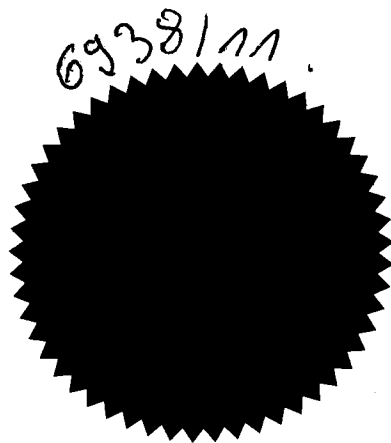

09/08 DELEGATED AUTHORITY

**I HEREBY CERTIFY THIS TO
BE A TRUE COPY OF THE
ORIGINAL DOCUMENT**

Tommy Kenihan

.....
Authorised Officer

WEST SUSSEX COUNTY COUNCIL

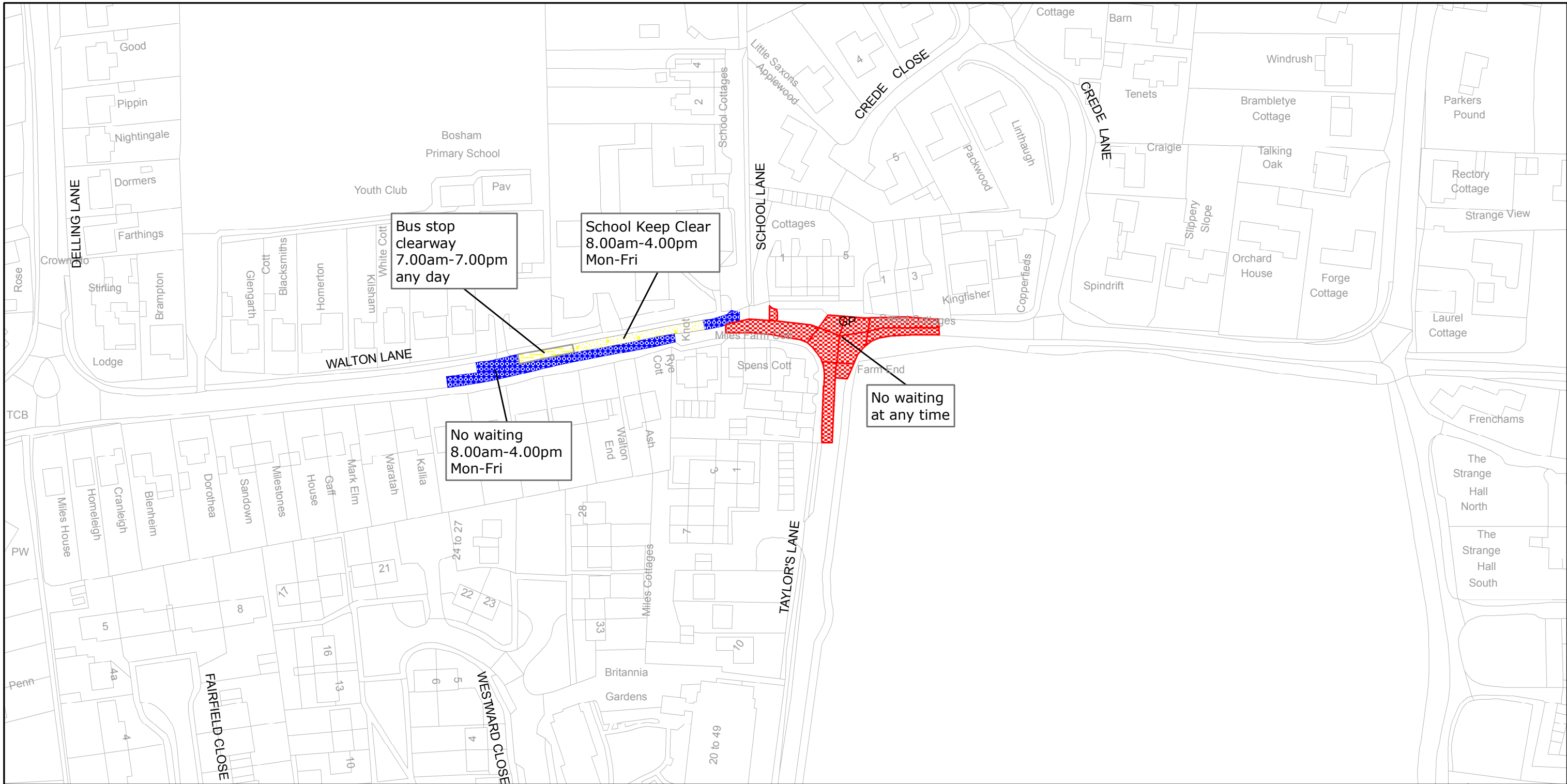

West Sussex County Council
 Infrastructure
 The Grange
 Tower Street
 Chichester
 West Sussex
 PO19 1RH

CHICHESTER DISTRICT: BOSHAM
 WAITING RESTRICTIONS

TILE REF NO:
SU8104SWN

SHEET ISSUE NO 2
 SHEET ACTIVE FROM - 03/06/2011

N

 SCALE:
 1:1250
 at A3 size

Reproduced from or based upon 2010 Ordnance Survey mapping with permission of the Controller of HMSO (c) Crown Copyright reserved.
 Unauthorised reproduction infringes Crown copyright and may lead to prosecution or civil proceedings West Sussex County Council Licence No. 100023447

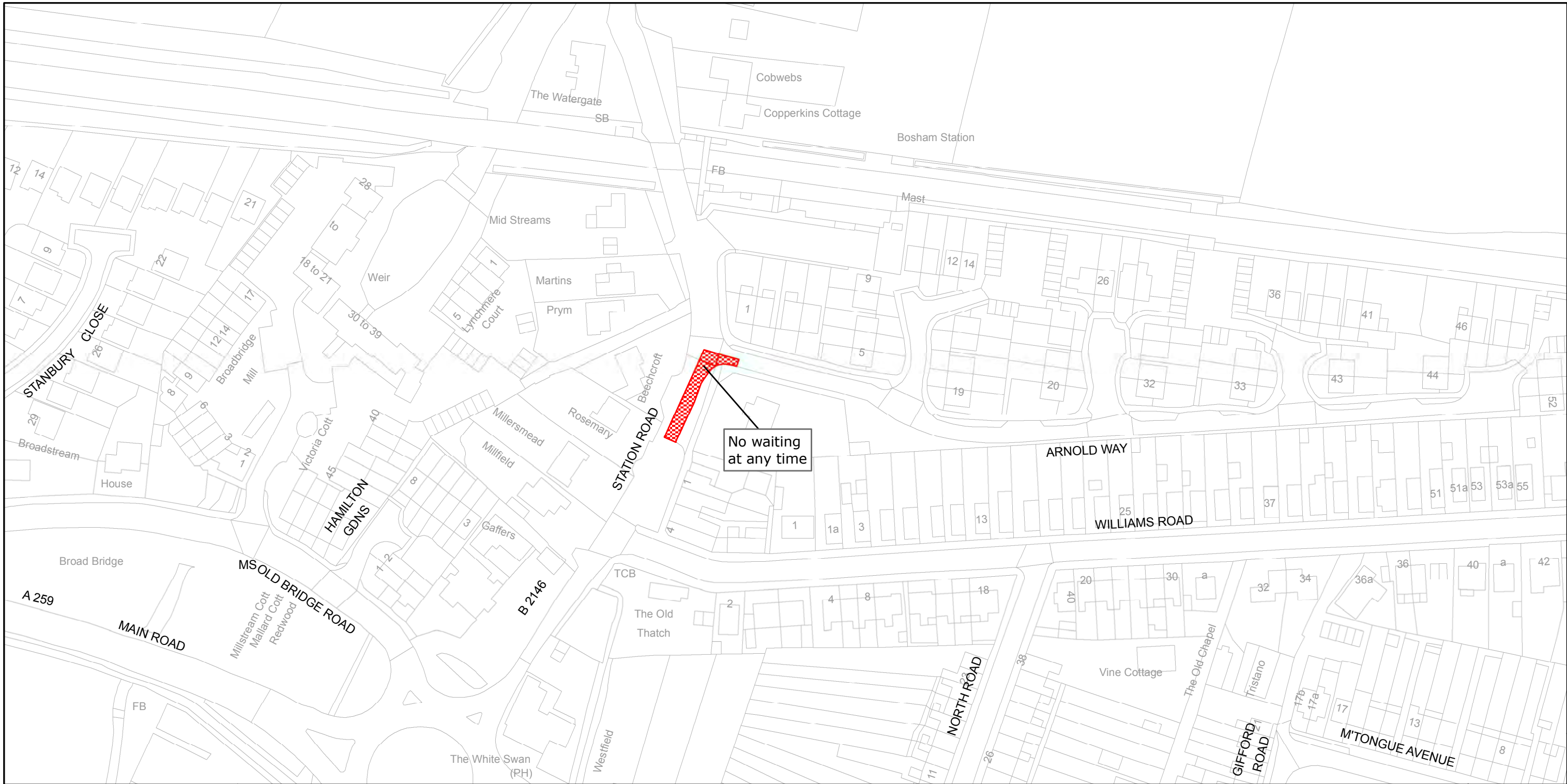

No waiting
at any time



West Sussex County Council
Infrastructure
The Grange
Tower Street
Chichester
West Sussex
PO19 1RH

CHICHESTER DISTRICT: BOSHAM
WAITING RESTRICTIONS

TILE REF NO:
SU8105SWN

SHEET ISSUE NO 1
SHEET ACTIVE FROM - 03/06/2011

N
SCALE:
1:1250
at A3 size

Reproduced from or based upon 2010 Ordnance Survey mapping with permission of the Controller of HMSO (c) Crown Copyright reserved.
Unauthorised reproduction infringes Crown copyright and may lead to prosecution or civil proceedings West Sussex County Council Licence No. 100023447

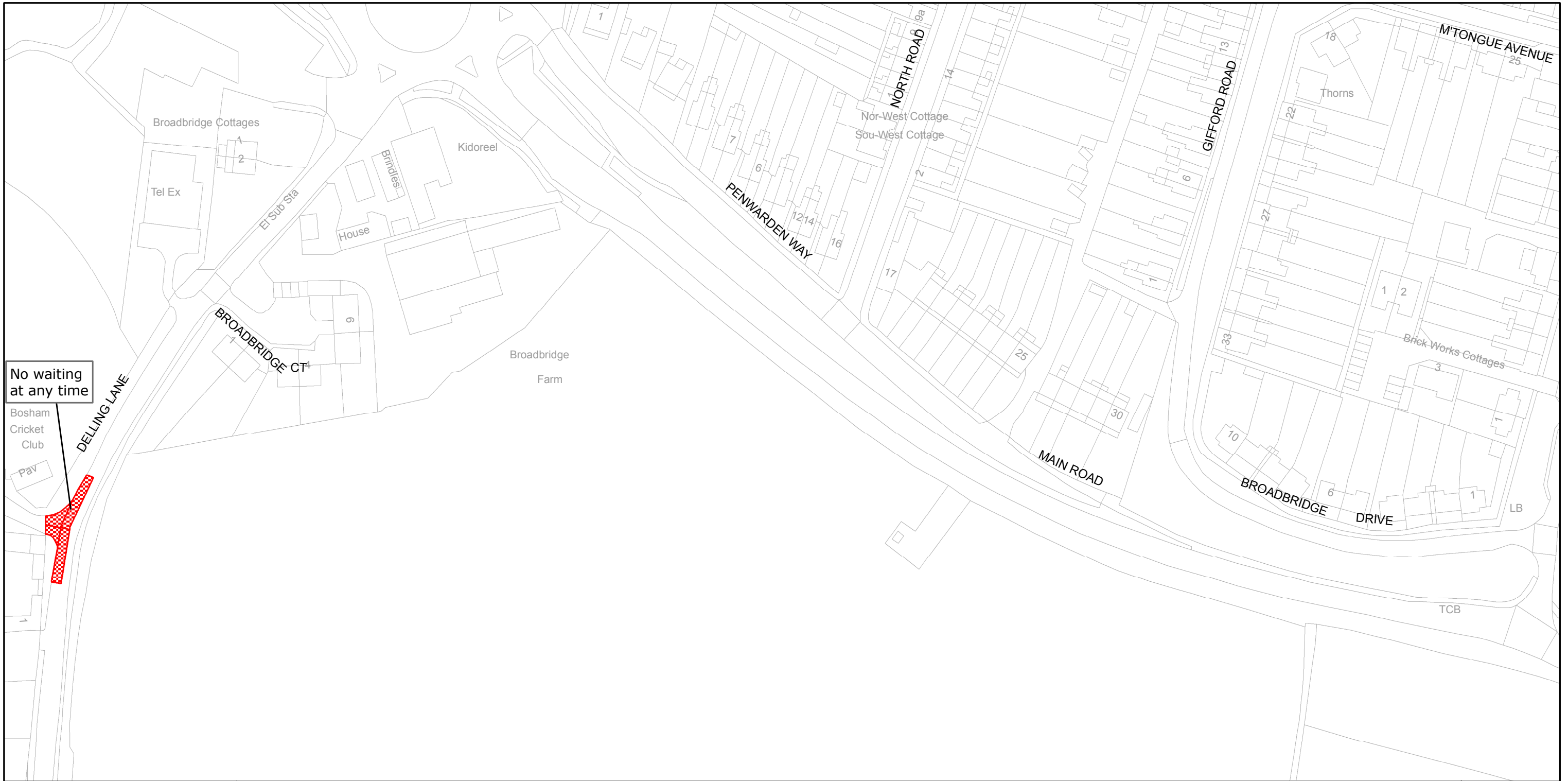

No waiting
at any time

Bosham
Cricket
Club
Pav



West Sussex County Council
Infrastructure
The Grange
Tower Street
Chichester
West Sussex
PO19 1RH

CHICHESTER DISTRICT: BOSHAM

WAITING RESTRICTIONS

TILE REF NO:
SU8105SWS

SHEET ISSUE NO 1
SHEET ACTIVE FROM - 03/06/2011

N

SCALE:
1:1250
at A3 size

Reproduced from or based upon 2010 Ordnance Survey mapping with permission of the Controller of HMSO (c) Crown Copyright reserved.
Unauthorised reproduction infringes Crown copyright and may lead to prosecution or civil proceedings West Sussex County Council Licence No. 100023447